

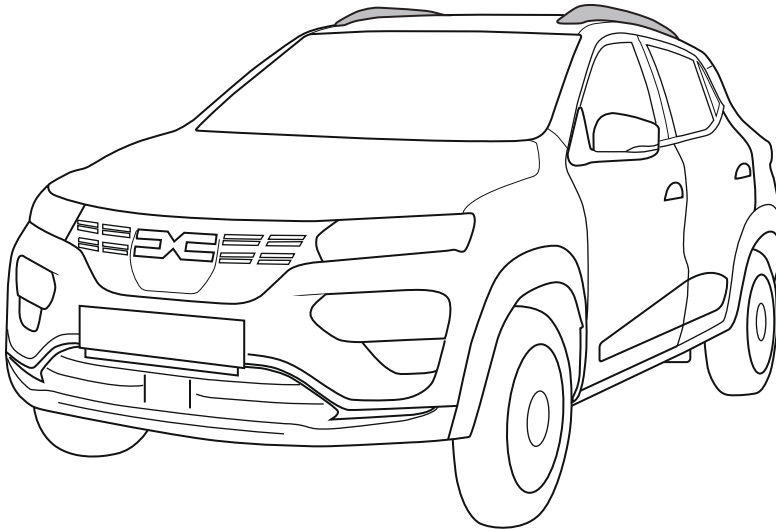

# SPRING

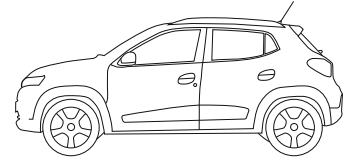

PART NUMBER	VARIANT
<b>738200989R</b>	<b>All</b>

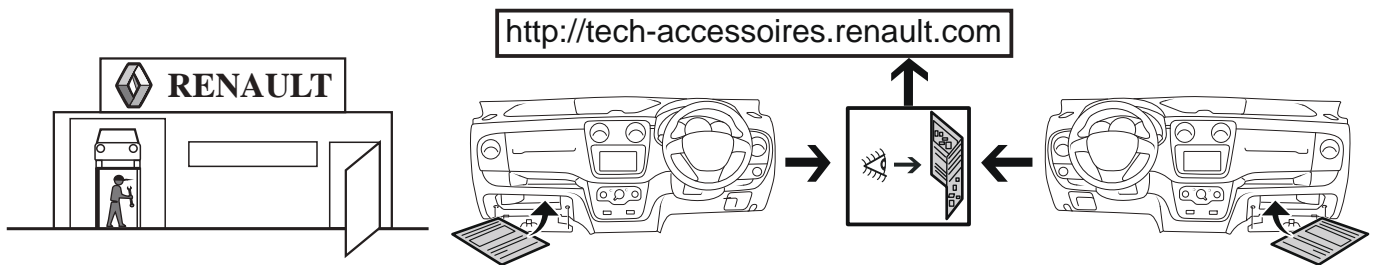

PART	PART IMAGE	QTY.
<b>(A)</b> Roof rail - RH		1
<b>(B)</b> Roof rail - LH		1
<b>(C)</b> Installation Manual		1

- |  |                                      |
|--|--------------------------------------|
| <b>(FRA)</b> Instructions de montage     | <b>(KOR)</b> 조립설명서                   |
| <b>(CES)</b> Pokyny pro montáž           | <b>(LIT)</b> Montavimo instrukcija   |
| <b>(DNK)</b> Monteringsveiledning        | <b>(LAV)</b> Montāžas instrukcijas   |
| <b>(DEU)</b> Einbauanleitung             | <b>(NLD)</b> Inbouwhandleiding       |
| <b>(ENG)</b> Installation instructions   | <b>(NOR)</b> Monteringsveiledning    |
| <b>(SPA)</b> Istrucciones de montaje     | <b>(POL)</b> Instrukcje wbudowania   |
| <b>(EST)</b> Paigaldusjuhised            | <b>(POR)</b> Instruções de montagem  |
| <b>(FIN)</b> Asennusohje                 | <b>(ROM)</b> Instrucțiuni de montaj  |
| <b>(ELL)</b> Οδηγίες συναρμολόγησης      | <b>(RUS)</b> Инструкция по монтажу   |
| <b>(HRV)</b> Návod k montáži             | <b>(SLK)</b> Návod na zabudovanie    |
| <b>(HUN)</b> Beépítési utasítások        | <b>(SLN)</b> Navodila za inštalacijo |
| <b>(ITA)</b> Istruzioni per il montaggio | <b>(SWE)</b> Montageanvisning        |
| <b>(JPN)</b> 取付説明書                       | <b>(TUR)</b> Montaj talimatları      |



# SPRING

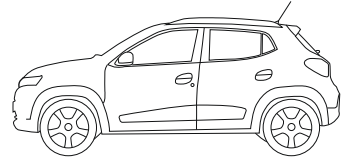

😊 OK

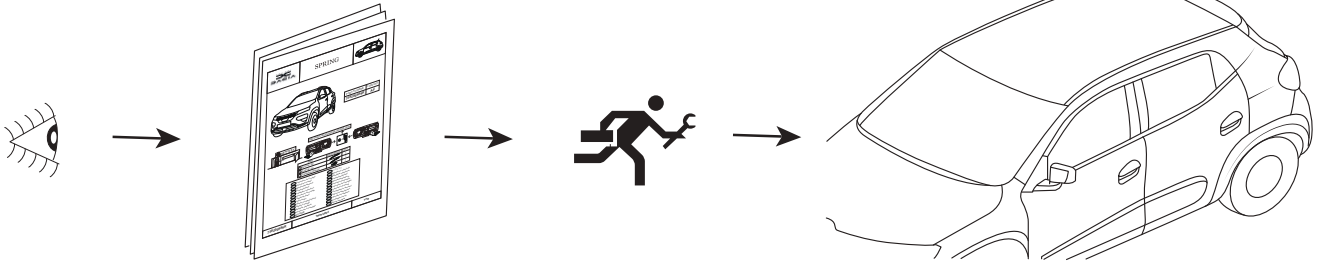

☹ NG

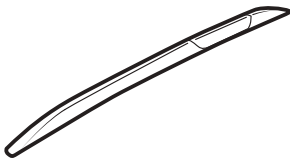
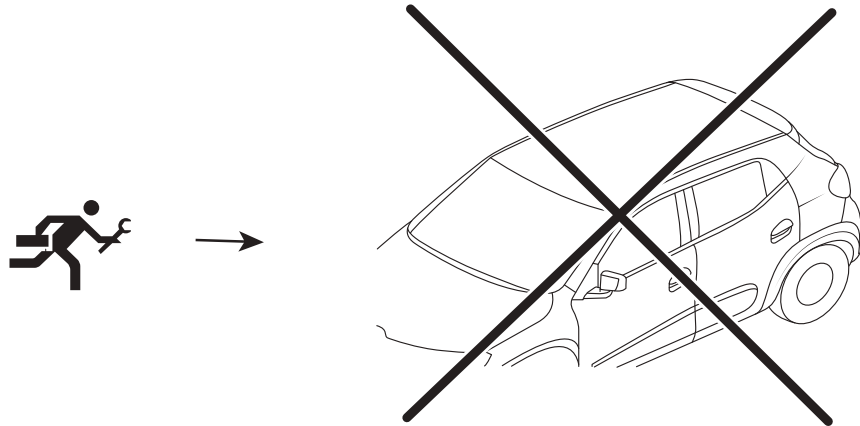

(A)

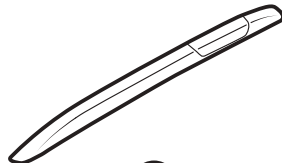

(B)

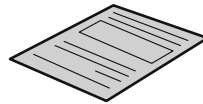

(C)

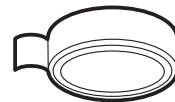

Masking Tape



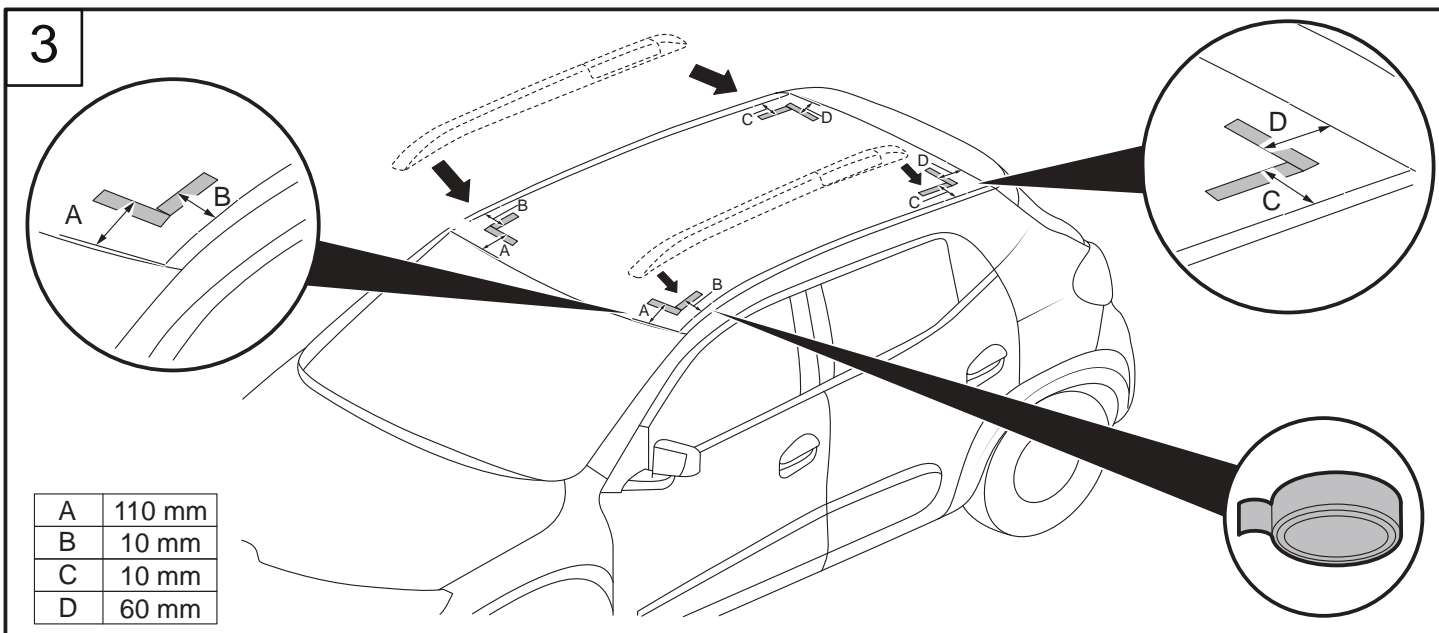
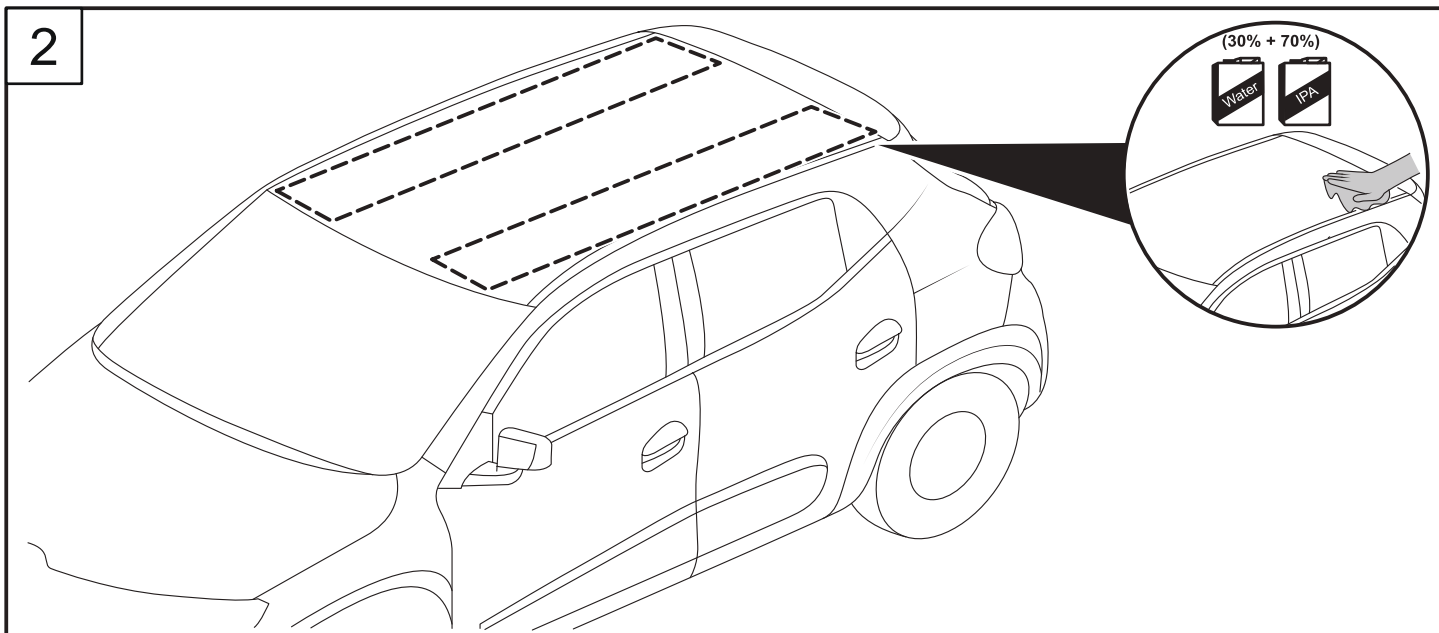
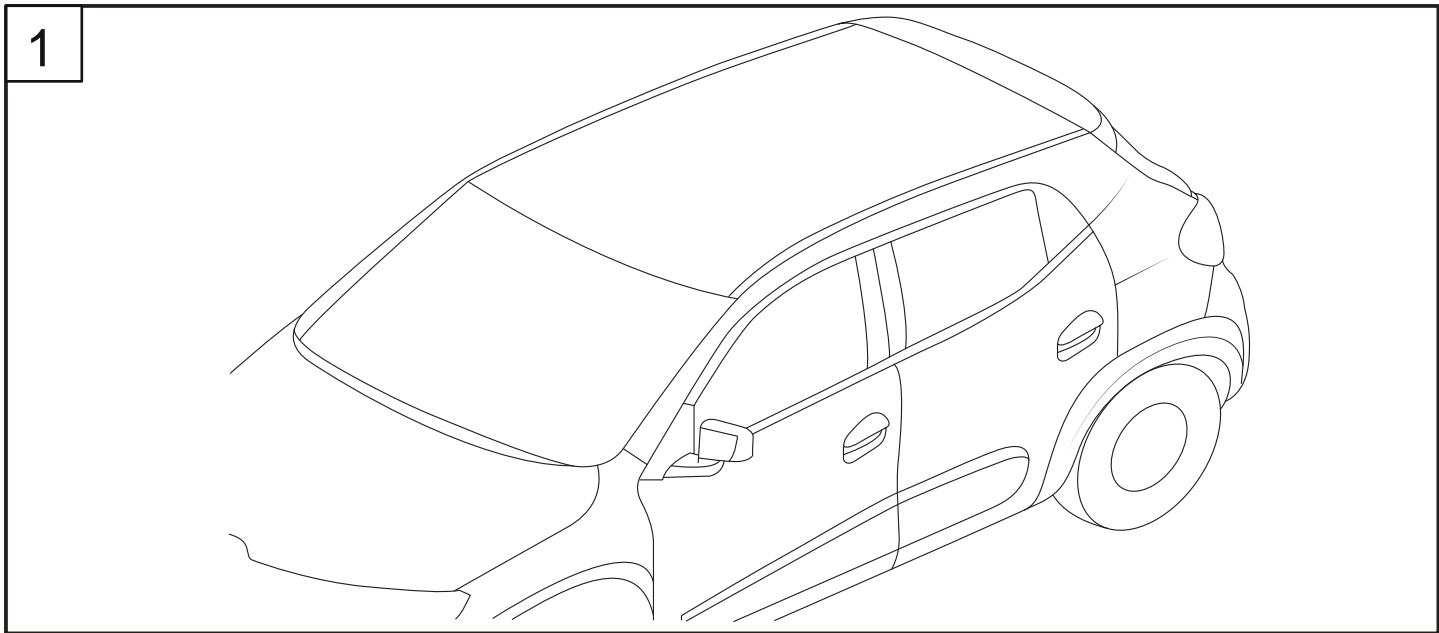

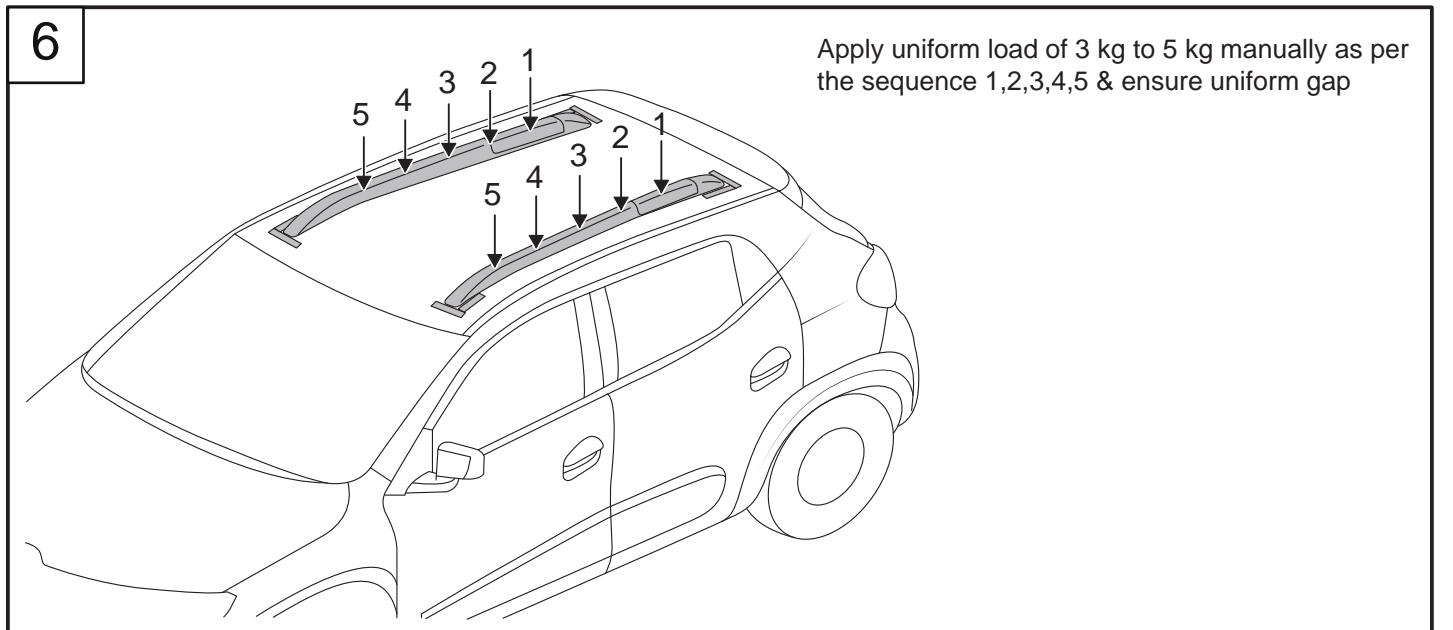
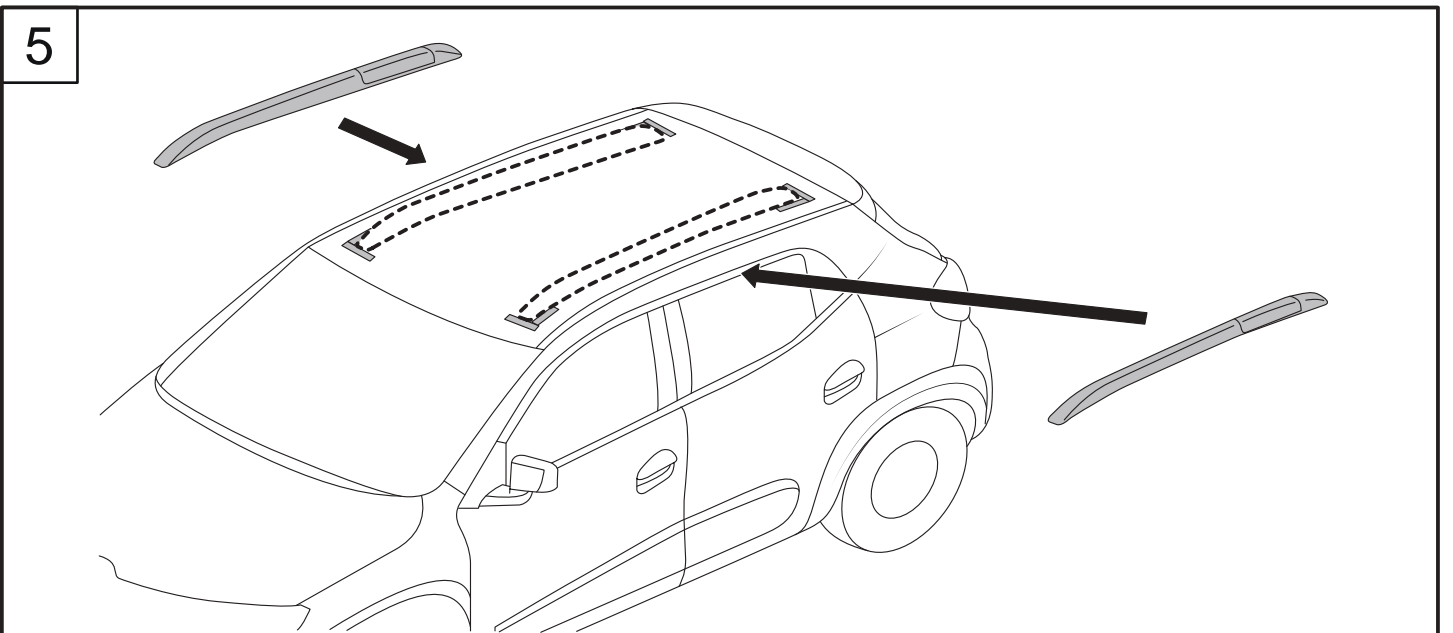
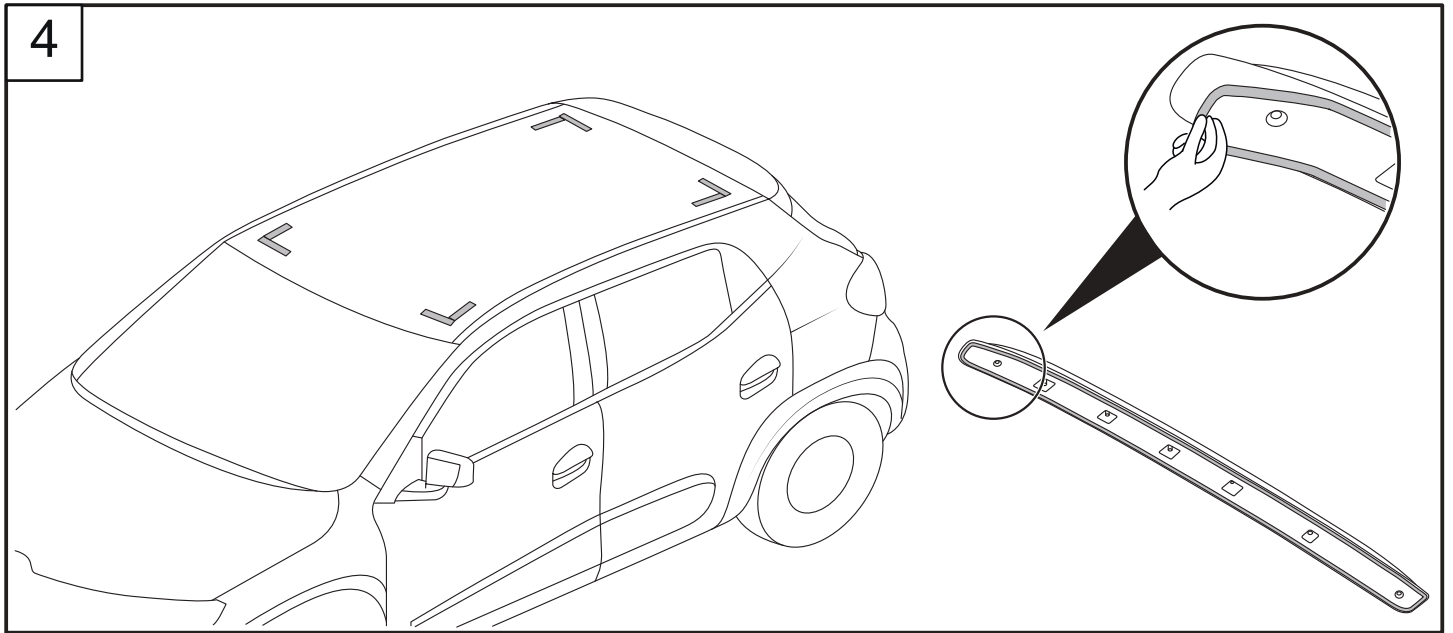

7

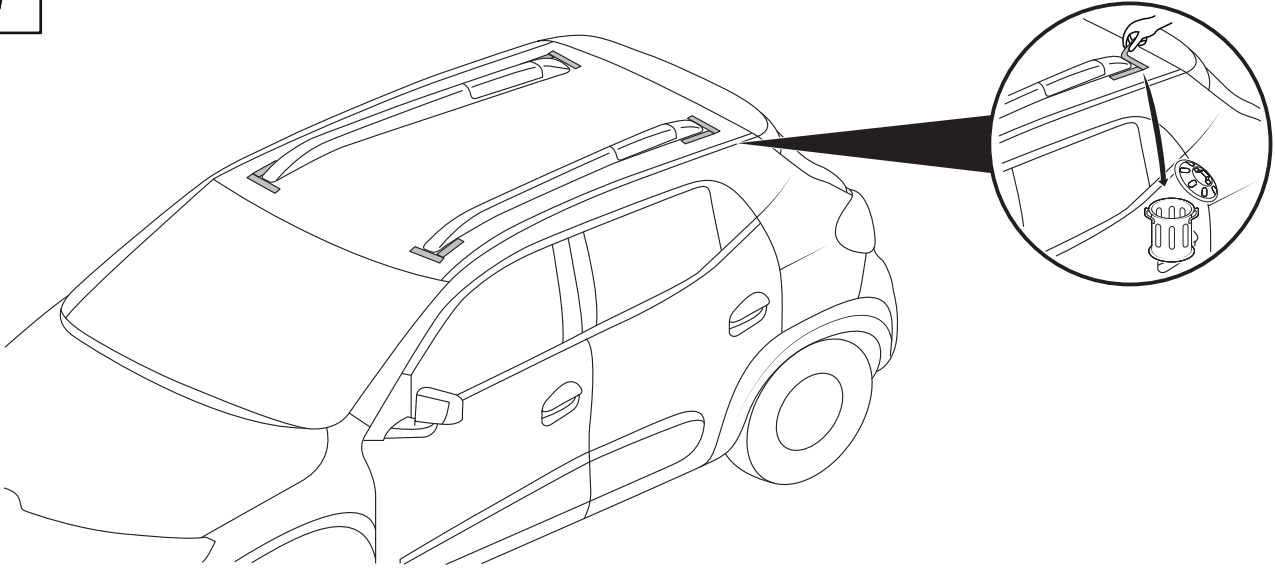

8

